

REAR AXLE BEAM ASSY

REPLACEMENT

1. REMOVE REAR WHEEL
2. REMOVE SKID CONTROL SENSOR WIRE
(See page 27-4)
3. REMOVE EXHAUST PIPE ASSY CENTER
4. SEPARATE PARKING BRAKE CABLE ASSY NO.3
(See page 27-4)
5. SEPARATE PARKING BRAKE CABLE ASSY NO.2
(See page 27-4)
6. LOOSEN REAR AXLE BEAM ASSY
(See page 27-4)
7. SEPARATE REAR BRAKE TUBE NO.4
(See page 27-4)
SST 09023-00100
8. SEPARATE REAR BRAKE TUBE NO.3
(See page 27-4)
SST 09023-00100
9. REMOVE REAR DISC BRAKE CALIPER ASSY, LH
 - (a) Remove the 2 bolts and separate the rear disc brake caliper assy.
10. REMOVE REAR DISC BRAKE CALIPER ASSY RH
HINT:
Remove the RH side by the same procedures with the LH side.
11. REMOVE REAR DISC
12. REMOVE REAR AXLE HUB & BEARING ASSY LH
(See page 30-28)
13. REMOVE REAR AXLE HUB & BEARING ASSY RH

HINT:
Remove the RH side by the same procedures with the LH side.
14. REMOVE PARKING BRAKE PLATE SUB-ASSY LH
 - (a) Remove the rear axle bearing retainer and parking brake plate LH.
15. REMOVE PARKING BRAKE PLATE SUB-ASSY RH

HINT:
Remove the RH side by the same procedures with LH side.
16. REMOVE LWR CONTROL ARM DYNAMIC DAMPER
 - (a) Remove the bolt.
- HINT:
Remove the RH side by the same procedures with LH side.
17. SEPARATE SHOCK ABSORBER ASSY REAR LH
(See page 27-4)
18. SEPARATE SHOCK ABSORBER ASSY REAR RH
(See page 27-4)

19. REMOVE COIL SPRING REAR LH(See [page 27-4](#))**20. REMOVE COIL SPRING REAR RH**(See [page 27-4](#))**21. REMOVE REAR COIL SPRING INSULATOR UPPER LH****22. REMOVE REAR COIL SPRING INSULATOR UPPER RH****23. REMOVE REAR AXLE BEAM ASSY**

- (a) Support the rear axle beam with jack.
- (b) Remove the 2 bolts, washers and nuts.
- (c) Remove the rear axle beam.

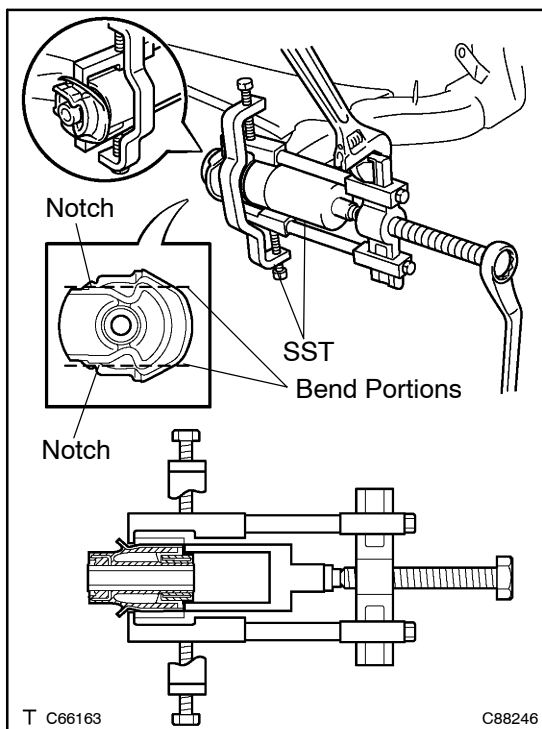
NOTICE:**Loosen the bolt and not the nut.****24. REMOVE REAR AXLE CARRIER BUSH LH**

- (a) Place matchmarks on the 2 notches of the bushing and axle beam.
- (b) Using a chisel and hammer, bend the 2 portions of the bushing rib.

HINT:

Bend the bushing rib until the claw of SST can be hung.

- (c) Using SST, remove the bushing from the axle beam.

SST 09950-40011 (09951-04020, 09952-04010, 09953-04030, 09954-04020, 09955-04051, 09957-04010, 09958-04011), 09950-60010 (09951-00630)

NOTICE:**If the axle beam has been scratched, apply the paint.****25. REMOVE REAR AXLE CARRIER BUSH RH****HINT:**

Remove the RH side by the same procedures with the LH side.

SST 09950-40011 (09951-04020, 09952-04010, 09953-04030, 09954-04020, 09955-04051, 09957-04010, 09958-04011), 09950-60010 (09951-00630)

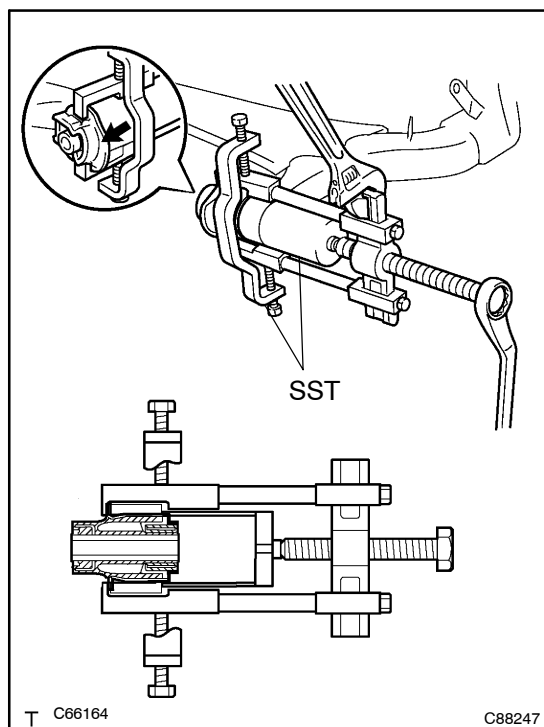

26. INSTALL REAR AXLE CARRIER BUSH LH

- (a) Align the matchmarks on the axle beam with the 2 notches of a new bushing and temporarily install the bushing to the axle beam.
- (b) Using SST, install the bushing to the axle beam.
 SST 09950-40011 (09951-04020, 09952-04010, 09953-04030, 09954-04020, 09955-04051, 09957-04010, 09958-04011), 09950-60010 (09951-00620), 09710-04101

NOTICE:

- Hang the claw of SST to the bushing deeply and firmly.
- Do not scratch the rubber portion of the bushing.
- Do not deform the bushing rib.

27. INSTALL REAR AXLE CARRIER BUSH RH

HINT:

Install the RH side by the same procedures with the LH side.

SST 09950-40011 (09951-04020, 09952-04010, 09953-04030, 09954-04020, 09955-04051, 09957-04010, 09958-04011), 09950-60010 (09951-00620), 09710-04101

28. TEMPORARY TIGHTEN REAR AXLE BEAM ASSY

- (a) Support the rear axle beam with jack.
- (b) Install the rear axle beam, 2 bolts, washers, and temporary tighten the 2 nuts.

29. INSTALL REAR COIL SPRING INSULATOR UPPER LH

(See page 27-4)

30. INSTALL REAR COIL SPRING INSULATOR UPPER RH

(See page 27-4)

31. INSTALL COIL SPRING REAR LH

(See page 27-4)

32. INSTALL COIL SPRING REAR RH

(See page 27-4)

33. CONNECT SHOCK ABSORBER ASSY REAR LH

(See page 27-11)

34. CONNECT SHOCK ABSORBER ASSY REAR RH

(See page 27-11)

35. INSTALL PARKING BRAKE PLATE SUB-ASSY LH

- (a) Install the 2 axle bearing retainers to the axle beam.
- (b) Install the parking brake plate LH to the axle beam.

36. INSTALL PARKING BRAKE PLATE SUB-ASSY RH

HINT:

Install the RH side by the same procedures with the LH side.

37. INSTALL REAR AXLE HUB & BEARING ASSY LH

(See page 30-28)

38. INSTALL REAR AXLE HUB & BEARING ASSY RH

HINT:

Install the RH side by the same procedures with the LH side.

39. INSTALL REAR DISC**40. INSTALL REAR DISC BRAKE CALIPER ASSY, LH**

(a) Install the 2 bolts and rear disc brake caliper assy to the rear axle beam.

Torque: 88 N·m (897 kgf·cm, 65 ft·lbf)

41. INSTALL REAR DISC BRAKE CALIPER ASSY RH

HINT:

Install the RH side by the same procedures with the LH side.

42. CONNECT REAR BRAKE TUBE NO.4

(See page 27-4)

SST 09023-00100

43. CONNECT REAR BRAKE TUBE NO.3

(See page 27-4)

SST 09023-00100

44. CONNECT PARKING BRAKE CABLE ASSY NO.2

(See page 27-4)

45. CONNECT PARKING BRAKE CABLE ASSY NO.3

(See page 27-4)

46. FULLY TIGHTEN REAR AXLE BEAM ASSY

(See page 27-4)

47. FULLY TIGHTEN SHOCK ABSORBER ASSY REAR LH

(See page 27-11)

48. FULLY TIGHTEN SHOCK ABSORBER ASSY REAR RH

(See page 27-11)

49. CONNECT SKID CONTROL SENSOR WIRE

(See page 27-4)

HINT:

Connect the RH side by the same procedures with the LH side.

50. INSTALL TAIL PIPE ASSY**51. INSTALL EXHAUST PIPE ASSY CENTER****52. INSTALL LWR CONTROL ARM DYNAMIC DAMPER**

(a) Install the dynamic damper with the bolt.

Torque: 30 N·m (306 kgf·cm, 22 ft·lbf)

53. BLEED BRAKE LINE (See page 32-4)**54. INSTALL REAR WHEEL**

Torque: 103 N·m (1,050 kgf·cm, 76 ft·lbf)

55. INSPECT BRAKE FLUID LEVEL IN RESERVOIR (See page 32-4)

- 56. □ INSPECT REAR WHEEL ALIGNMENT (See page 27-3)
- 57. □ INSPECT SPEED SENSOR (See page 05-295)